

WNG_BATTEN

A theater rigging batten family that may be used as part of a lineset assembly, or simply to represent a lineset batten location in plan.

FAMILY INFORMATION

Manufacturer	Wenger / JR Clancy
Revit Category	Specialty Equipment
LOD	350
Host	Unhosted / Workplane
Masterformat	11 61 00
Uniformat	E1070.10
Omniclass	23.40.50.14.14
PB Version	23.1.1.0
PB ID Number	RFA-007-01020303-0002

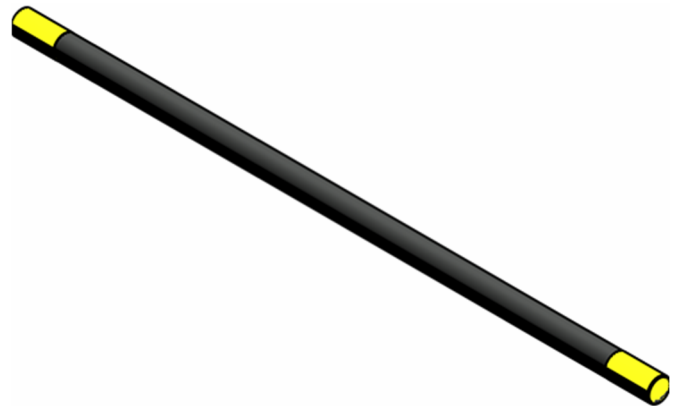

PRODUCT INFORMATION

Manufacturer	Wenger / JR Clancy
Series	Summit Theatron
Product Models	N/A
Assembly Code	N/A

FAMILY TYPES

N/A

PARAMETER INFORMATION

Parameter Flexing

The family may be flexed through type parameters and instance parameters. Please note that parameter names in uppercase are schedulable Shared Parameters. Parameters included in the following groups are intended to be user editable:

- Constraints
- Graphics
- Materials and Finishes

Changing parameters in any other group risks “breaking” the family, and is not supported.

User Editable Parameter Descriptions

Type Parameters

Batten Material	Material applied to the batten. Default is Metal, Black
Pipe End Material	Material applied to the end of the batten when Pipe End Visible is turned on. Default is Plastic, Yellow.

Instance Parameters

Length	Adjusts the length of the batten. Note that the batten may also be adjusted by aligning and locking its ends or stretching via grips.
LINESET ID	Allows a name or ID to be applied to the lineset for scheduling.
LINSET DESCRIPTION	Allows a text description to be applied to the lineset for scheduling.
LINESET DISTANCE	Allows a distance to be input to schedule a distance from a reference, such as a plaster line.
USE DYNAMIC SCHEDULING	Enables the dynamic scheduling function for the PBIM Rigging Tools, allowing a lineset or batten to move relative to a selected reference plane. The add-in available at https://www.performancebim.com/p-rigging .
Pipe End Visible	Turns on the visibility of the pipe end segment that uses the Pipe End Material.

USE INSTRUCTIONS

Insertion & Placement

The family may be inserted either through Insert -> Load Family, dragging into a project window, or via a content management system (as applicable). The insertion point of the batten is its center. Hosting to a level or custom workplane is recommended. Once the family is placed, a length value may directly entered into the Length parameter. Or after placing and selecting the batten, grips on either end of the tube allow the family to be stretched in either direction.

Customization

The only available customization is the material parameter.

Other Parameters

As indicated on Page 2, while there are other parameters that are open to adjustment, **Performance BIM only supports user-editing parameters in the Constraints, Graphics, Materials and Finishes, and Identity Data groups. Any changes to other groups is done at the user's risk, and will not be supported by Performance BIM.**

Detail Levels

Detail Levels

The family will look the same at any detail level.